

Ultrasonic Aromatherapy Diffuser

Create a relaxing atmosphere at home or at the office with the Ultrasonic Aromatherapy Diffuser. It uses high-frequency ultrasonic vibrations to create a fine mist, suffusing the air with the scent of your favorite essential oil. Dual-button control allows you to easily change the setting of your mist, as well as the light that provides a soft white illumination through the frosted glass cover. Quiet, energy-efficient and safe, it even has an auto shut-off when the water level gets too low.

Note: Be careful while handling the diffuser; the glass cover is fragile and is not attached to the plastic base. When moving the diffuser, hold the base with one hand and hold the glass cover with the other.

Assembly

Step 1. Carefully remove the glass cover and the water tank cover (Figure 1). Place the diffuser base on a level surface where you intend to use it. To prevent damage to the machine, it's best not to move it after adding water. **Caution:** Do not place the diffuser on wooden or painted surfaces that can be damaged by essential oils. Keep the diffuser upright at all times to avoid spilling and possible damage.

Step 2. Use a cup to fill the water tank with lukewarm (not cold) regular tap water. Do not fill it past the maximum water line. **NOTE:** Do not use distilled, purified or filtered water. They prevent the ultrasonic ionizer from working properly.

Step 3. Add 2 to 5 drops of an essential oil to the water tank.

Step 4. Place the water tank cover and the glass cover back onto the diffuser. Make sure both pieces are fully in place.

Step 5. Plug the AC adapter connector into the back of the diffuser's base and then plug the AC adaptor into an electrical outlet.

Important: Do not tip the machine after filling with water; doing so may cause water to flow into the internal parts of the machine, causing damage. If this occurs, unplug and empty the water tank. Allow it to air dry in a well-ventilated place for three days before refilling.



Figure 1

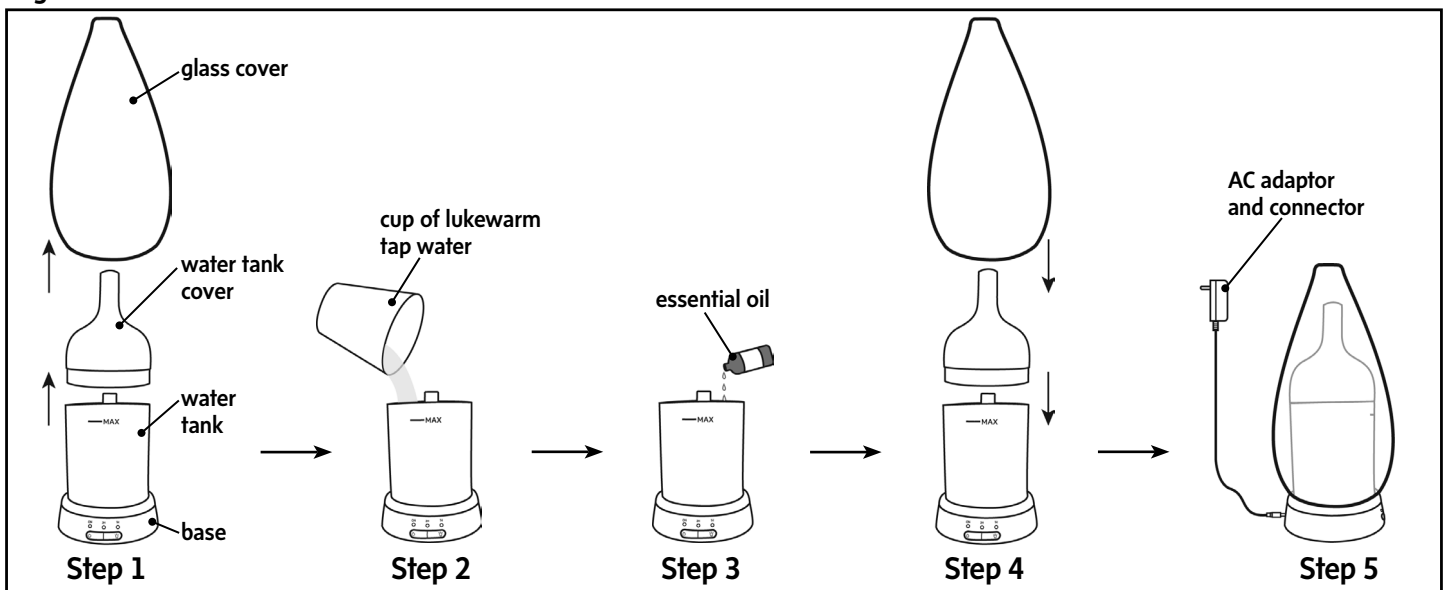

over please

Operation

Press the Power Button on the front of the diffuser (Figure 2) to cycle through these settings:

- Turns on the diffuser with a continuous mist. The 'ON' light switches on.
- Sets the mist on a 2 hour timer. The '2H' light switches on.
- Sets the mist on a 1 hour timer. The '1H' light switches on and the '2H' light switches off.
- Turns off the diffuser. All lights on the base will switch off.

Press the Light Button (Figure 2) to change the setting of the light that shines through the frosted glass cover. It will cycle through Bright, Medium, Low and Off.

Note: When the water level in the tank drops too low, the diffuser shuts off automatically. If that happens, unplug the unit and add water, following the Assembly instructions.

Figure 2

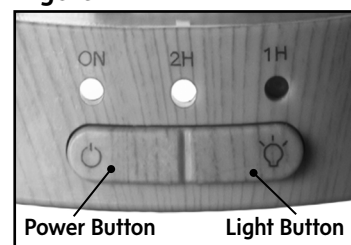

Maintenance and Cleaning

We recommend changing the water in the tank and cleaning the diffuser 1-2 times a week, or any time you want to change the fragrance. If the lights on the base of the diffuser start flashing, it means that the Mist Sensor Disc at the bottom of the water tank is dirty and needs to be cleaned (Figure 3).

To clean the diffuser, turn it off and unplug it. Remove the glass cover and the water tank cover. Pour the water out of the tank on the side opposite the vent (Figure 4). Clean the inside of the diffuser with a soft, damp cloth. Do not use corrosive detergents. Carefully rub the Mist Sensor Disc at the bottom of the tank with a cotton swab, taking care not to scratch it (Figure 3).

Figure 3

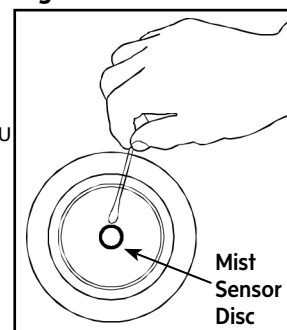

Precautions

- For adult use.
- Use only with the power supply provided with the unit.
- Use in an environment between 50 °F and 85 °F.
- Always add water before adding essential oils; do not use pure essential oils without water.
- Unplug the diffuser before cleaning or refilling. Empty the tank when the diffuser is not in use.
- Do not remove the lid or cover the diffuser when it is in use.
- If water inadvertently gets into the vent, unplug the diffuser immediately and leave it to dry for at least 3 days before reusing it.

Figure 4

Important: The vent leads to the diffuser's electronics. Do not allow water into the vent as this may damage the diffuser.

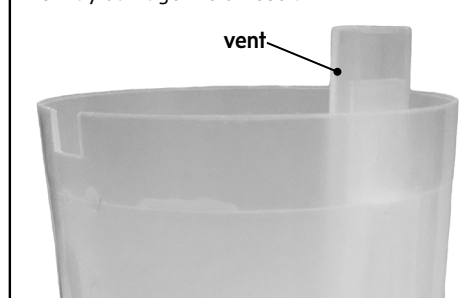

Troubleshooting

The diffuser gives off little to no mist:

- You used distilled, purified or filtered water. Change it to regular tap water.
- The water level is higher than the maximum water line. Empty and clean the diffuser. Fill the water tank halfway and test to make sure you get mist before adding more water.
- The diffuser needs to be cleaned. Follow the instructions above.

The diffuser will not stop running even though the water tank is empty:

- The Mist Sensor Disc is dirty. Clean it following the instructions above.

The diffuser is spraying water instead of mist:

- The water is too cold. Change it to lukewarm water.
- The water tank cover is not secure. Make sure all pieces of the diffuser are assembled correctly.

Disclaimer

- Gardener's Supply Company vendors develop and manufacture aroma diffusers.
- These diffusers are not intended to treat, cure, prevent or diagnose any disease or health condition.
- We do strongly recommend to those who are looking for a treatment for a particular disease or health condition to consult a qualified integrative physician prior to using this diffuser.
- We recommend consulting a qualified aromatherapist before starting aromatherapy.
- Gardener's Supply Company is not responsible for the use or misuse, abuse, negligence, accidents or lack of maintenance of this device.
- Gardener's Supply Company shall in no event be liable for death, injuries to persons or property, or for incidental, contingent, special or consequential damages arising from the use of this product or the effects of the use thereof.