

Deep Root Raised Beds - 2', 3' & 4' Long

GARDENERS
SUPPLY COMPANY
812-260-2128 • gardeners.com
service@gardeners.com

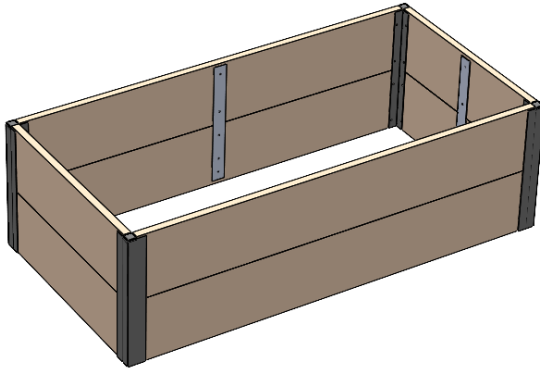

Tools Required:

Drill or Driver
with Phillips bit



Two people recommended for assembly

Parts List:

A

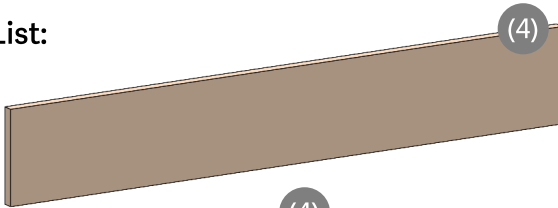

B

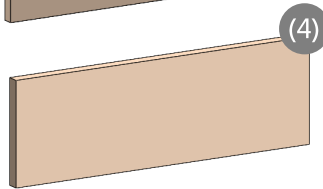

C

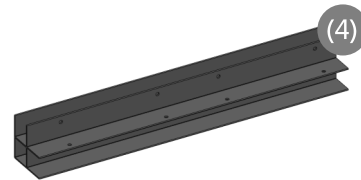

D

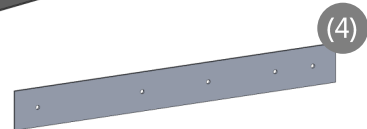

F



E



1. Locate a level area and prepare the ground for planting. If installing on lawn, remove sod and loosen soil to a depth of 6".

2. Press a cap (F) into the top of each leg (C) using a mallet if necessary.

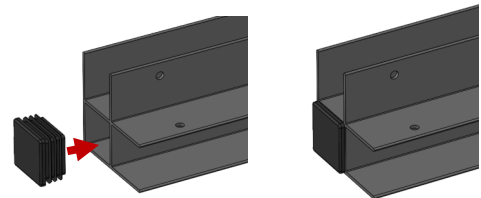

3. Working on a flat surface, align the short ends of two long boards (A) with the rough face up. Place one flat stock (D) at the center as shown below. Make sure boards (A) are flush and tight and secure the flat stock (D) with screws (E). Repeat for second long panel (A) and twice more for the short boards (B). (Note: for a 2x2, 3x3, or 4x4 bed, all 4 panels will be the same size)

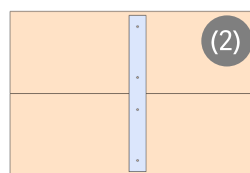
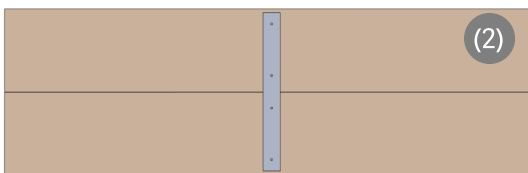

4. Slide an aluminum leg (C) over each end. Ensure the leg (C) is tight against the board and secure with screws (E).

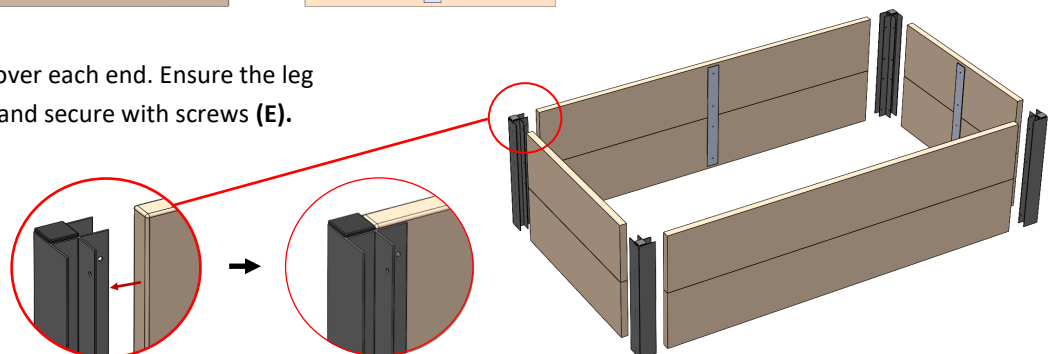

PLEASE
RECYCLE