

Deep Root Raised Beds - 12' Long



812-260-2128 | gardeners.com
service@gardeners.com

Tools Required:

Drill or Driver
with Phillips bit



Two people recommended for assembly

Parts List:

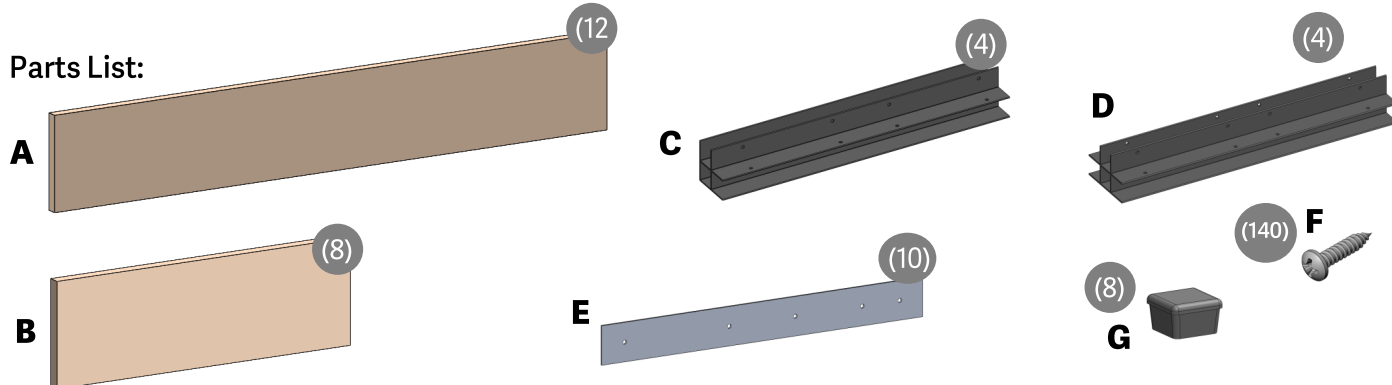

1. Locate a level area and prepare the ground for planting. If installing on lawn, remove sod and loosen soil to a depth of 6".

2. Press a cap (**G**) into the top of each leg (**C**) and (**D**) using a mallet if necessary.

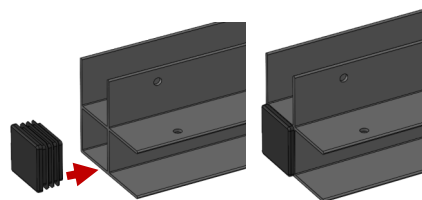

3. Working on a flat surface, align the short ends of two long boards (**A**) with the rough face up. Place one flat stock (**E**) at the center as shown below. Make sure boards (**A**) are flush and tight and secure the flat stock (**E**) with screws (**F**). Repeat for second long panel (**A**) and twice more for the short boards (**B**).

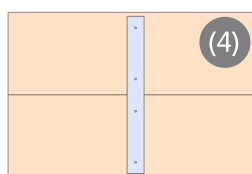
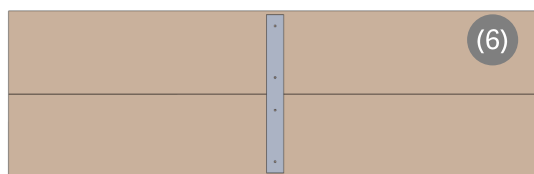

4. Slide an aluminum leg (**C**) over each end. Ensure the leg (**C**) is tight against the board and secure with screws (**F**).

5. The inline connectors (**D**) are located in the middle as shown at right and connect two long panels (**A**) on either side and a short panel (**B**) in the middle.

